

RHC TEXAS LIVING. DELIVERED.

SPECIFICATIONS

Box Size: 8' x 16'
Type: Mobile Camp
7' Walls

Floor:

Skid: 2layer 2x10
Insulation: R-19
Joists: 2" x 8" x 93"
Decking: 3/4" ShureGuard
Floor Covering: 1/8" Vinyl Tile (6 mill)

Exterior:

Studs: 2" x 4" x 79.5" on 16" Center
Bottom Plate: 2" x 4"
Top Plate: Double 2" x 4"
Sheathing: none
Insulation: R-13
Siding: 29ga. Painted Steel
Trim: 26ga. Painted Steel

Interior:

Studs: 2" x 4" x 79.5" on 16" Center
Covering: 1/4" Paneling
Closets: (1) 30" Clothes Rod
Cabinets: San Antonio or Café
Counter Top: Formica (Terra Roca)
Lofts: none

Roof:

Truss: 2" x 6" double slope on 24" Center
Ceiling: Sea Spray Gypsum Sheetrock
Insulation: R-19
Decking: 7/16" OSB
Roofing: Rubber
Trim: 26ga. Painted Steel
Anchoring Straps: none

Doors:

Exterior Door: (1) 36" x 80" Tell 24ga. Steel Door
Interior Door: (1) 24" x 80" Stain Grade

Hardware: Brushed Nickel

Windows:

Window: (1) 46" x 27" Bronze Frame single panel

Electrical:

Load Panel: (1) 125 Amp Exterior Box
Wiring: #12 Romex
Lights: (2) 4' Diffused (1) Globe
Phone or Data Box: none
Receptacles: (5) 15amp.
GFI Receptacles: (1) Inside (1) Outside
Miscellaneous:

Plumbing:

Bathroom: (1) Three Quarter Bath
Water Closets: std
Lavatory: 15" Bar Sink w/ Mirror
Water Heater: 6 gal Tank
DWV: All drain lines connected (one stub out)

HVAC:

A/C - Heating: (1) 12000 btu
Duct: Through Wall Heat / Cool Units
Diffusers: none
Returns: none
Exhaust Fans: none

Appliances:

RHC TEXAS LIVING. DELIVERED.

SPECIFICATIONS

Box Size: 8' x 20'
Type: Mobile Camp
7' Walls

Floor:

Skid: 2layer 2x10
Insulation: R-19
Joists: 2" x 8" x 93"
Decking: 3/4" ShureGuard
Floor Covering: 1/8" Vinyl Tile (6 mill)

Exterior:

Studs: 2" x 4" x 79.5" on 16" Center
Bottom Plate: 2" x 4"
Top Plate: Double 2" x 4"
Sheathing: none
Insulation: R-13
Siding: 29ga. Painted Steel
Trim: 26ga. Painted Steel

Interior:

Studs: 2" x 4" x 79.5" on 16" Center
Covering: 1/4" Paneling
Closets: (1) 30" Clothes Rod
Cabinets: San Antonio or Café
Counter Top: Formica (Terra Roca)
Lofts: none

Roof:

Truss: 2" x 6" double slope on 24" Center
Ceiling: Sea Spray Gypsum Sheetrock
Insulation: R-19
Decking: 7/16" OSB
Roofing: Rubber
Trim: 26ga. Painted Steel
Anchoring Straps: none

Doors:

Exterior Door: (1) 36" x 80" Tell 24ga. Steel Door
Interior Door: (1) 24" x 80" Stain Grade

Hardware: Brushed Nickel

Windows:

Window: (1) 46" x 27" Bronze Frame single panel

Electrical:

Load Panel: (1) 125 Amp Exterior Box
Wiring: #12 Romex
Lights: (2) 4' Diffused (1) Globe
Phone or Data Box: none
Receptacles: (6) 15amp.
GFI Receptacles: (1) Inside (1) Outside
Miscellaneous:

Plumbing:

Bathroom: (1) Three Quarter Bath
Water Closets: std
Lavatory: 15" Bar Sink w/ Mirror
Water Heater: 6 gal Tank
DWV: All drain lines connected (one stub out)

HVAC:

A/C - Heating: (1) 12000 btu
Duct: Through Wall Heat / Cool Units
Diffusers: none
Returns: none
Exhaust Fans: none

Appliances:

Shelf Cedar 18" x 30" for Microwave

RHC TEXAS LIVING. DELIVERED.

Super Combo Trailers

- 16' - 7,000 Lb Capacity
- 20' - 10,400 Lb Capacity
- Winch Package/Battery not included

Standard Sizes

- 8X16 with bath
- 8X16 without bath
- 8X20 with bath

Appliances (Note: must be wired direct, no RV plug)

- Under Counter Refrigerator
- On Demand Water Heater Upgrade
- Two Burner Cooktop
- Under Cabinet Microwave With Vent For Cooktop

Furniture

- Bunk Bed set with inner spring mattresses
- Night Stand

Decoration

- Antler Towel Holder
- Antler TP Holder
- Antler Lamp

Camouflage

- Camo Corners
- Camo Shutters
- Camo Door
- Camo Breaker Box

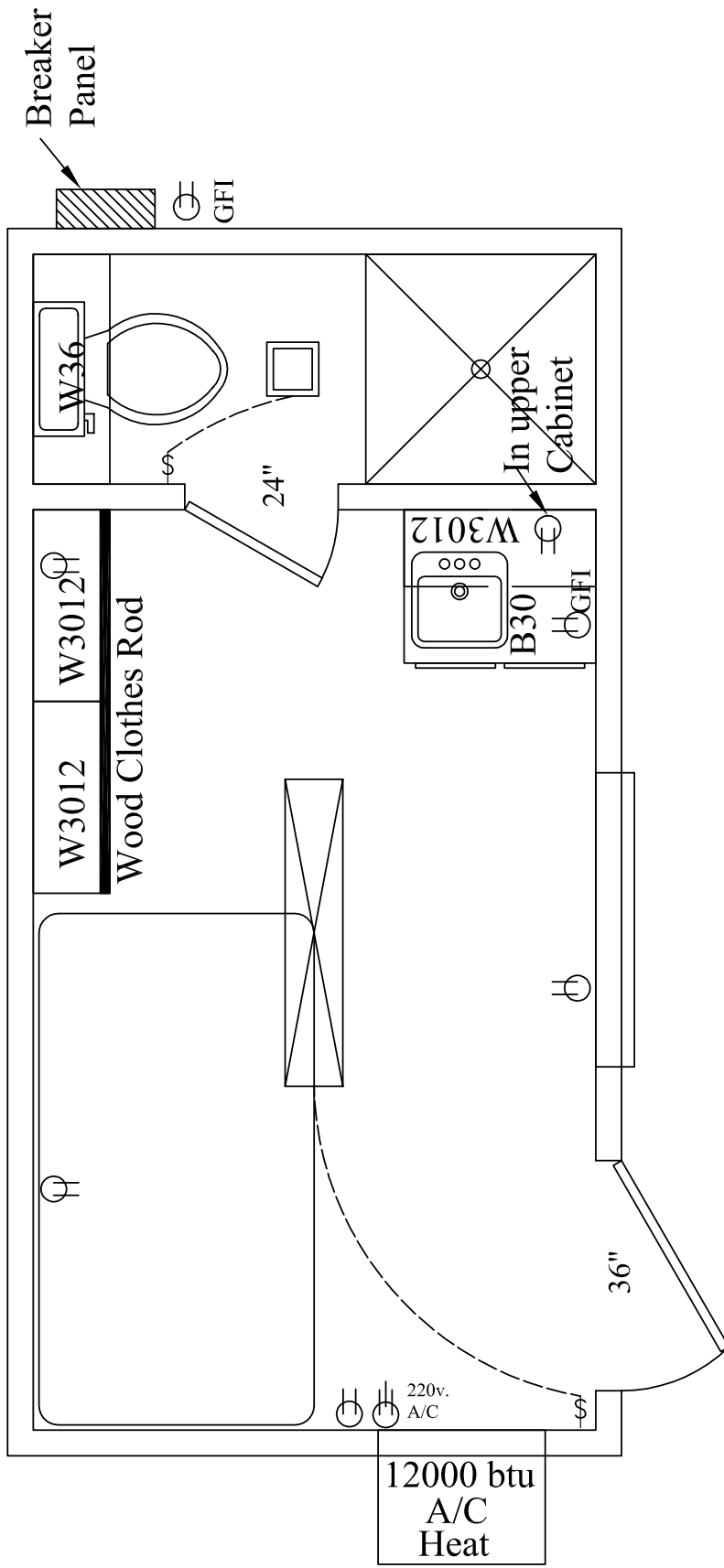

DEER CAMP - 08x16 Double Slope

Deer Camp
GS-0816-DC



Main Room 2x10 TREATED SKIDS

BATH
HandiCap Toilet
Shower
Tile

Cabinets
Can Lights
Bar Sink
Refrig. under Cab.

Tile
Cabinets
Paneling
Roof
Metal
Trim
Misc.

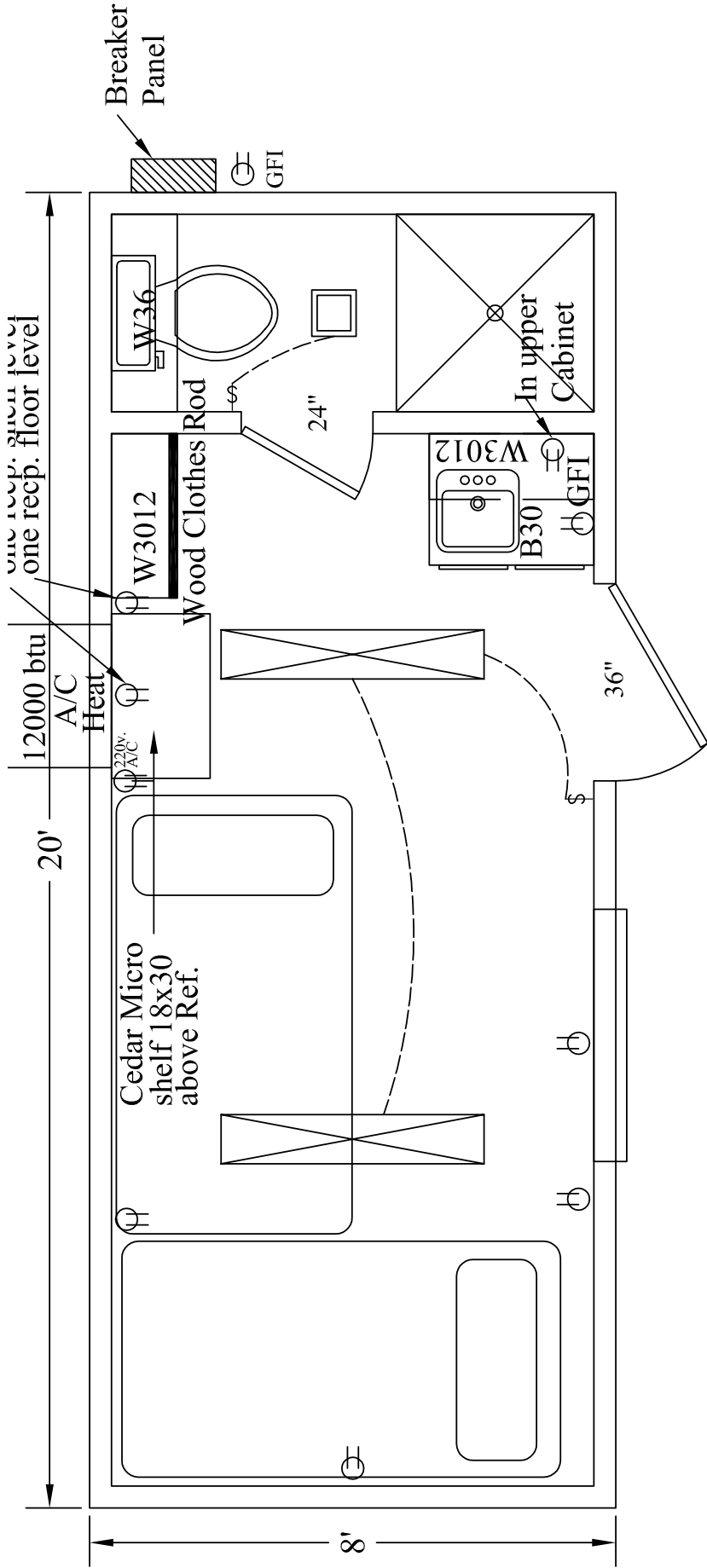

DEER CAMP - 08x20 Double Slope

Deer Camp
GS-0820-DC



BATH Main Room 2x10 TREATED SKIDS

HandiCap Toilet
Shower
Tile
Cabinets
Flourescent Lights
Bar Sink

Tile	
Cabinets	
Paneling	
Roof	
Metal	
Trim	
Misc.	